

GUILFORD ROAD

IRON BRIDGE ROAD

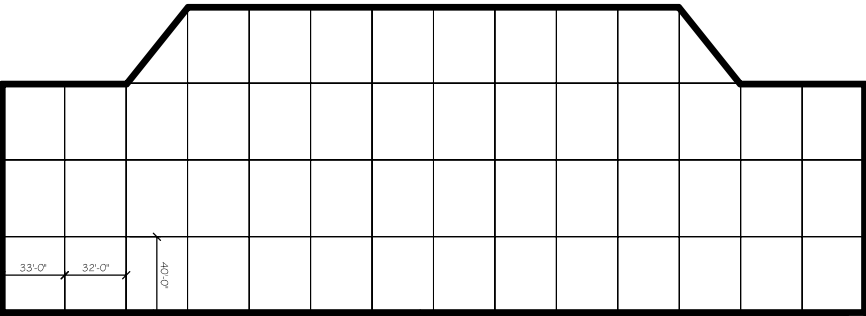

100'-0"

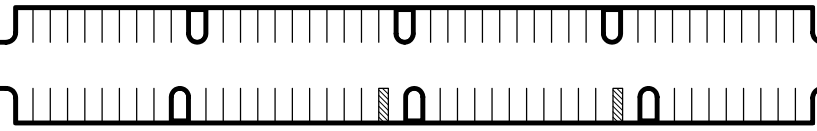
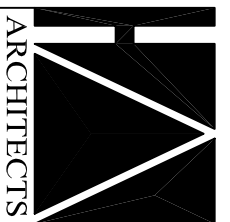
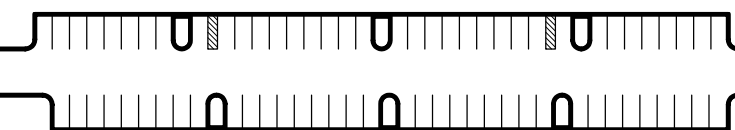
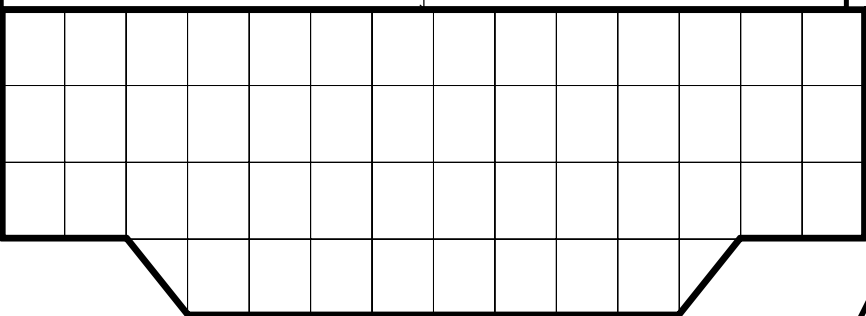

ARCHITECTS
HOFMANN
ASSOCIATES,
INC.

SCALE: 1" = 100'-0"

PROJECT NAME:
**CORRIDOR NORTH
INDUSTRIAL PARK**
10611 & 10621 IRON BRIDGE ROAD
JESSUP, MARYLAND 20794

DEVELOPER:
JAMES F. KNOTT DEVELOPMENT
CORPORATION

THE CONCEPTS, IDEAS, DESIGNS
AND DRAWINGS SHOWN ON THIS SHEET
FOR THE PROJECT SPECIFIED ON
THIS SHEET AND ARE THE SOLE
PROPERTY OF HOFMANN
ASSOCIATES, INC. THEY ARE NOT TO
BE REPRODUCED OR USED BY
OTHERS WITHOUT WRITTEN
PERMISSION OF HOFMANN
ASSOCIATES, INC.

**PROPOSED
SITE PLAN**

Issue date : 12/01/04
project no. : 04-154